

CLAW SPRING PIN REPLACEMENT

READ THESE INSTRUCTIONS COMPLETELY BEFORE YOU START. IF YOU DON'T UNDERSTAND THESE INSTRUCTIONS, PLEASE CALL 800-453-1192 FOR ASSISTANCE

Procedure for replacing the spring pin on Little Giant Ladder Systems **Extension** ladders.

1. Failure to comply with all instructions may result in serious injury.
2. Make sure this kit is compatible with your ladder. If you have any questions concerning the use of this kit on Little Giant Ladder Systems products, call 800-453-1192 for assistance.
3. Before installing this kit, identify all kit components. If any components are missing or damaged, please contact Customer Care. Do not substitute any components.
4. Inspect the ladder before installing this kit. Repair or replace any damaged or missing ladder parts before using the ladder. Use only Little Giant Ladder Systems repair or replacement parts. If you are unable to repair it, discard the ladder.

COMPONENTS IN KIT 31632



(1) SOCKET HEAD BOLT



(1) PUSH PIN

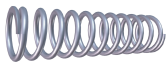

(1) SPRING



(1) 5/16 WASHER

TOOLS NEEDED

(2) 5/32" Allen Wrench

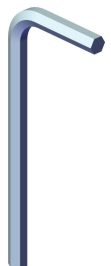

NOTE: IF ANY OTHER PART OF THE LADDER IS DAMAGED BEFORE OR DURING THE PROCESS OF INSTALLING AND/OR REPAIRING, DISCARD THE LADDER OR CONTACT CUSTOMER CARE FOR INSTRUCTIONS.

DO NOT USE A DAMAGED LADDER!

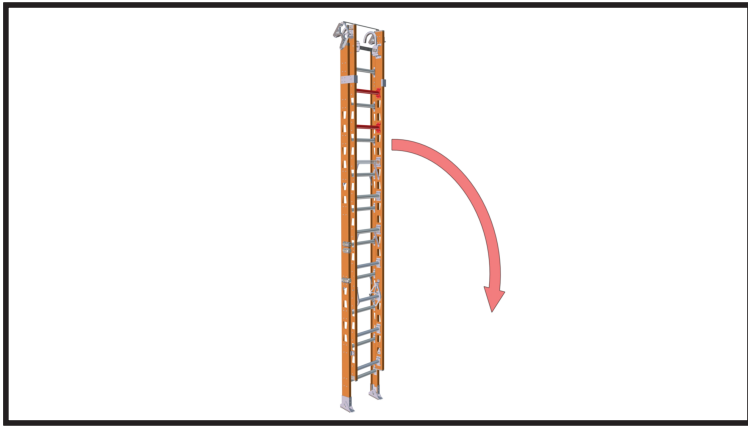

1. Lay the ladder down to make the following steps easier.

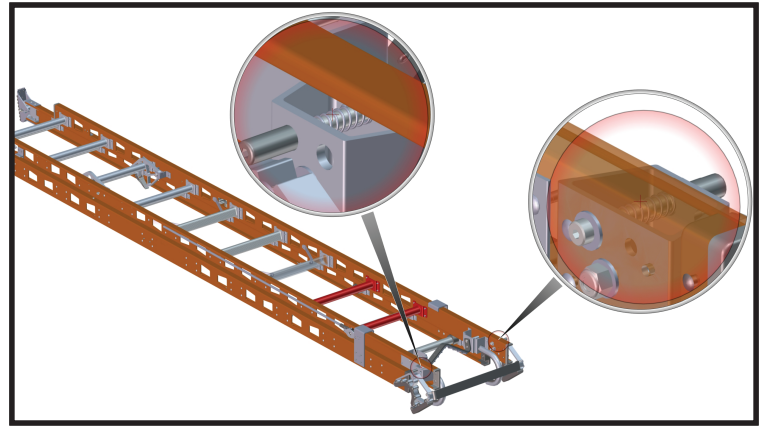

2. Identify the (existing) spring pin that needs to be replaced.

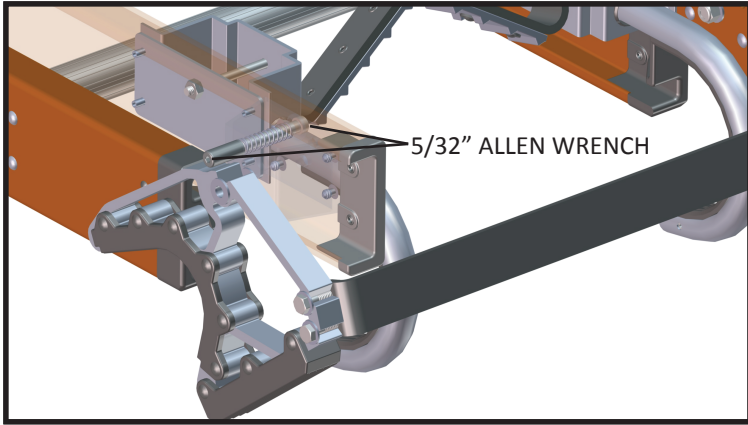

3. Using (2) 5/32" Allen Wrenches, loosen the Push Pin and the Socket Head Bolt.

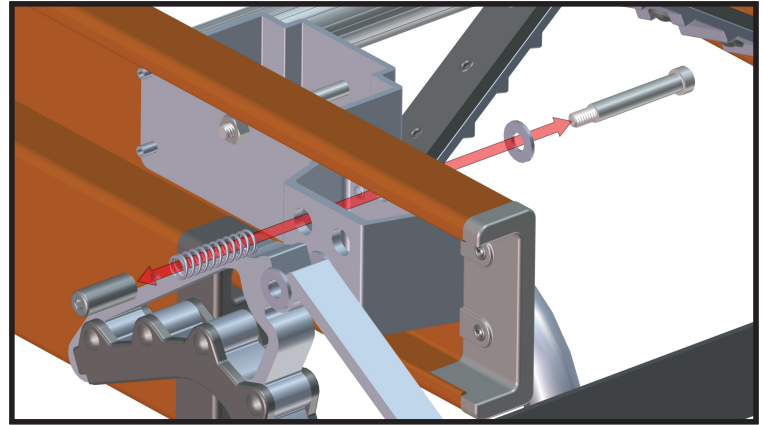

4. Remove and discard the Socket Head Bolt, Push Pin, Locking Spring and 5/16" Washer.

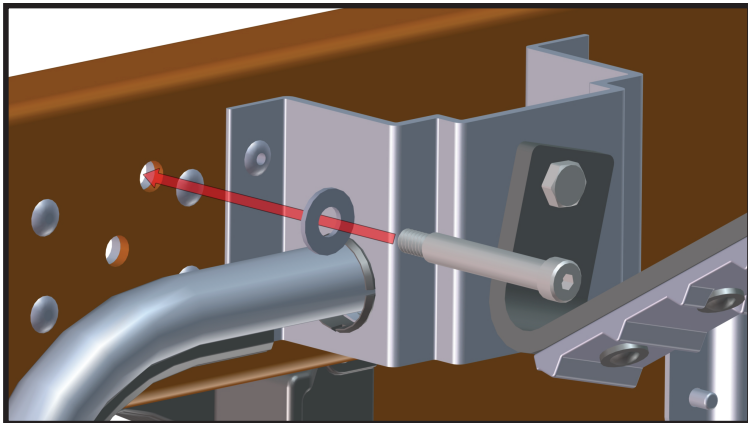

5. Insert the (new) Socket Head Bolt through the (new) 5/16" Washer and into the rail, as shown in the illustration.

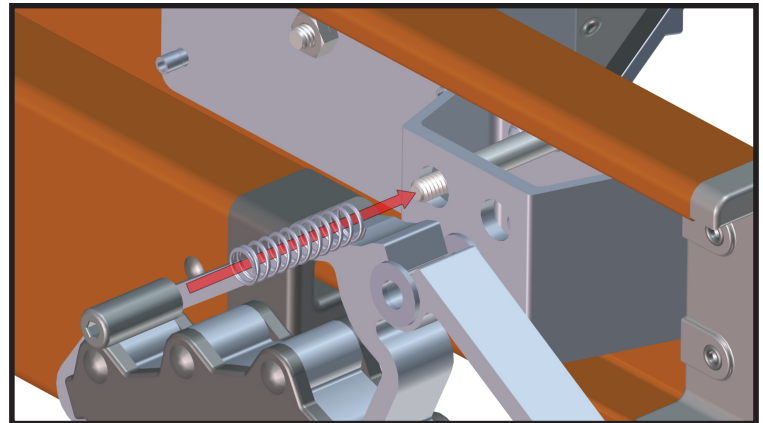

6. Insert the (new) spring and Push Pin onto the (new) Socket Head Bolt, as shown in the illustration. Tighten using (2) 5/32" Allen wrenches.

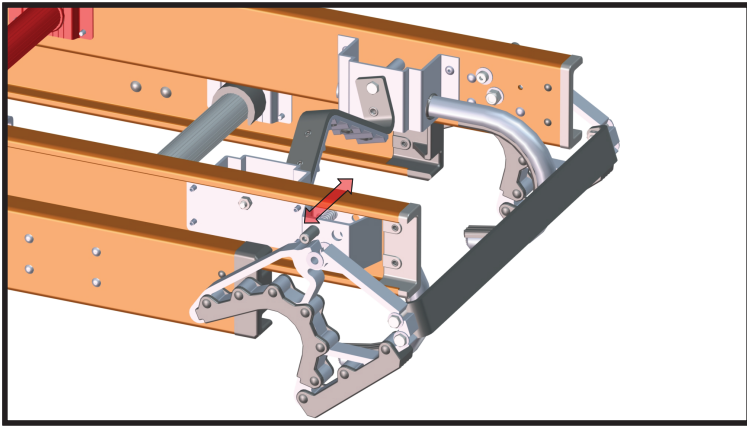

7. Once all steps are completed, depress the Spring pin several times and make sure that it moves smoothly, and springs back into position.